



## WMX 814 Chain actuator



Natural  
ventilation

24V

±24V control



MotorLink®



TrueSpeed™

TrueSpeed™

1.47

### Description

- designed for surface mounting
- for comfort ventilation
- to be used with tophung, bottomhung and turning windows
- to be used together with ±24V control units or control units with MotorLink®
- can be used together with espagnolette WMB
- synchronization of up to four window actuators – no need for an external synchronization module
- genuine position feedback and three speeds when using control unit with MotorLink®
- soft close function
- the electronics in this actuator can be programmed to suit specific requirements – i.e. pressure- and traction force, stroke, speed/sound level – with the WAT 100 programming box, also possible following installation
- built-in electronic load switch-off/end stop
- electronic actuator with micro controller
- the actuator has an integrated reverse function to ensure a prolonged life span of the window gaskets

### Actuator variants

The actuator is available in four different versions: single actuator (-1), double actuator (-2), triple actuator (-3) and quad actuator (-4).

The synchro actuators (-2, -3 and -4) are equipped with a patented synchronization function, in which the actuators communicate directly with each other, which ensures the actuators operate at exactly the same speed and position.

On large windows up to four actuators can be mounted on the same window – with no need for an external synchronization module.

### Pressure safety function

The risk of entrapment is reduced as the actuators are programmed to reverse if they encounter obstacles when closing. The set points determining when the actuators are to reverse are individually adjustable and can be adjusted also after installation using the programming box WAT 100.



Version S

### Opening speeds

#### One speed:

Actuators connected to  $\pm 24$  VDC control units (e.g. WUC) can run with one speed – see the following page for opening speed.

#### Three speeds:

Actuators connected to control units with MotorLink® (e.g. WCC) can run with three different speeds:

- automatically control speed – actuators run slowly and almost soundlessly.
- manual control speed – actuators run faster and more audibly.
- H&S and safety control speed – actuators run fastest. H&S control always has highest priority.

### Technical specifications

<b>Pressure force</b>	See diagram
<b>Traction force</b>	See diagram
<b>Locking force</b>	2000N
<b>Chain stroke</b>	50 – 1000mm in increments of 10mm. Special version up to 1000mm possible (only for bottom hung windows) – contact WindowMaster for further information.
<b>Opening Speed</b>	1-17 mm/s (TrueSpeed™)
<b>Window type</b>	Tophung, bottomhung and turning windows
<b>Power consumption</b>	24V DC (max. 10% ripple)
<b>Voltage</b>	20-36V DC
<b>Open-circuit voltage</b>	Max. 36V DC
<b>Current consumption</b>	max. 1A
<b>Operating conditions</b>	-5°C - +74°C. Max. 90% relative humidity (not condensing)
<b>Switch-on-duration</b>	ED 40% (max. 4min. per 10min)
<b>Material</b>	anodized aluminium housing with steel chain. grey actuators: 5m grey silicone cable 3-cores 0.34mm <sup>2</sup> black actuators: 5m black silicone cable 3-cores 0.34mm <sup>2</sup>
<b>Colour</b>	Anodized natural aluminium and anodized black. RAL colours available at an additional price
<b>Size</b>	25 x 37mm (H x D), length (L) depending on chain stroke – see table.
<b>Weight</b>	400mm stroke: 1.36kg; 600mm stroke: 1.58kg; 800mm stroke: 1.80kg; 1000mm stroke: 1.97kg
<b>IP rating</b>	Surface mounted: IP 20, concealed: IP 32
<b>Life span</b>	Tested with 10,000 opening and closing movements
<b>Delivery</b>	actuator with 5m cable and fast-in/fast-on connector for WLL cable
<b>To be ordered separately</b>	Brackets and standard extension cables type WLL
<b>Note</b>	We reserve the right to make technical changes

Chain stroke [mm]	Length (L) [mm] (incl. screws = 18mm)
400	563
600	663
800	763
1000	863

Item code composition						
WMX 814	n	x	xxxx	x	0	1
						<b>Product version: 1</b>
						<b>Certification: 0 = CE</b>
						<b>Actuator hardware version: S = standard</b>
						<b>Chain opening: 50 – 1000mm, in increments of 10mm (0050 = 50mm)</b>
						<b>Colour: B = black, G = grey</b>
						<b>Actuator variant: 1= single, 2 = double, 3 = triple, 4 = quad</b>
Explanation of product code structure						
<b>WMX 814-2B0170S 01</b>	WMX 814 actuator, double synchronisation, black, 170mm chain stroke, with CE certification, product version 1					

Accessories	Item no.
Chain bracket with tight-fitting bolt, WMX, for sash or frame	WAB 801
Actuator bracket, matt finish stainless steel	WAB 814A 0101
Actuator bracket, black RAL 9005	WAB 814A 2101
Actuator bracket, matt finish stainless steel	WAB 814B 0101
Actuator bracket, black RAL 9005	WAB 814B 2101
Actuator bracket, matt finish stainless steel	WAB 814C 0101
Actuator bracket, black RAL 9005	WAB 814C 2101
Actuator bracket for inwards opening windows, matt finish stainless steel	WAB 814I 0101
Actuator bracket for inwards opening windows, black RAL 9005	WAB 814I 2101
Z bracket for sash, matt finish stainless steel	WAB 814Z 0101
Z bracket for sash, black RAL 9005	WAB 814Z 2101
<b>See separate product sheets for further information.</b>	

### Installation suggestion 1

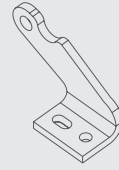
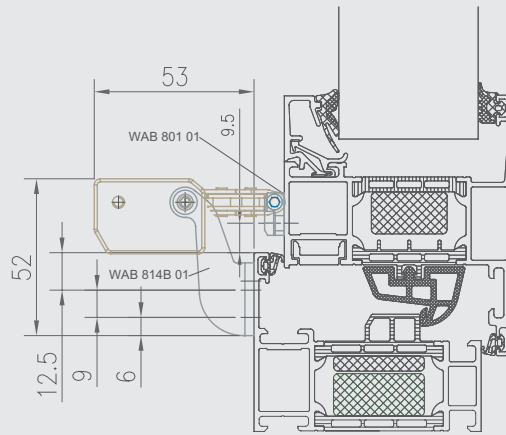

WAB 814B

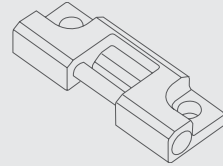

WAB 801

### Installation suggestion 2

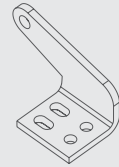
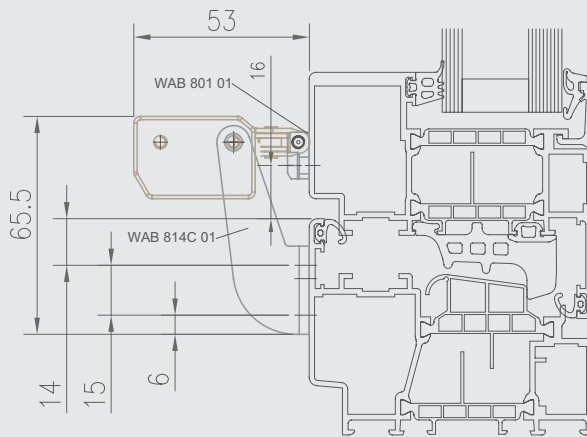

WAB 814C

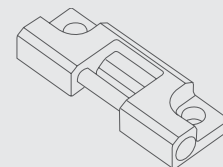

WAB 801

### Installation suggestion 3

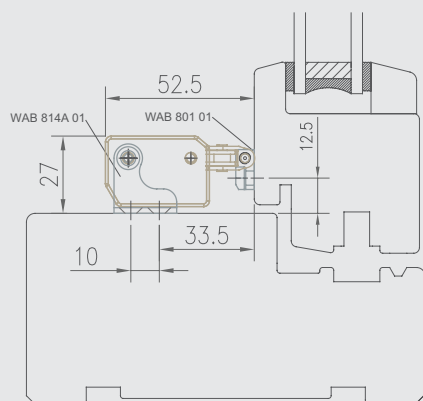

WAB 814A

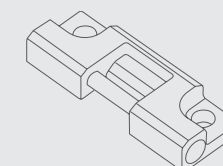

WAB 801

WMX 814

# Chain actuator

## Installation suggestion 4

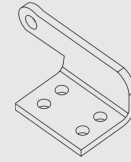
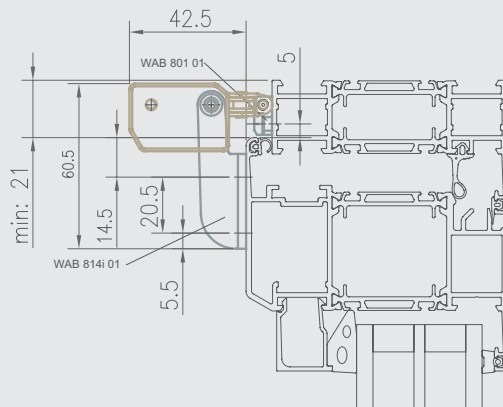

WAB 814i

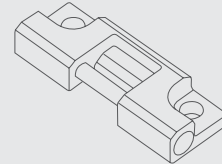

WAB 801

## Installation suggestion 5

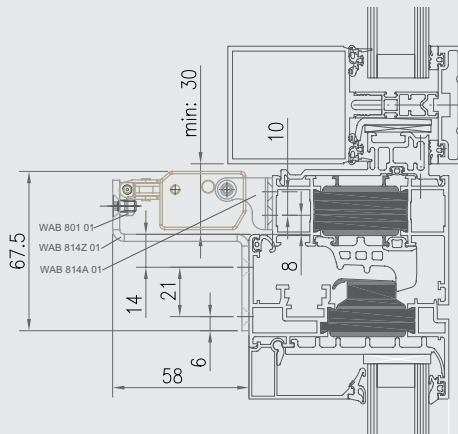

WAB 814A

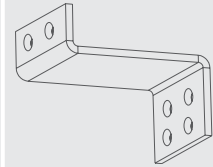

WAB 814Z

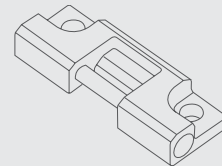

WAB 801

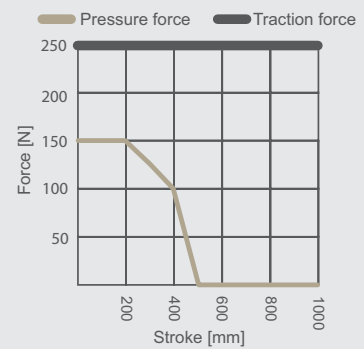
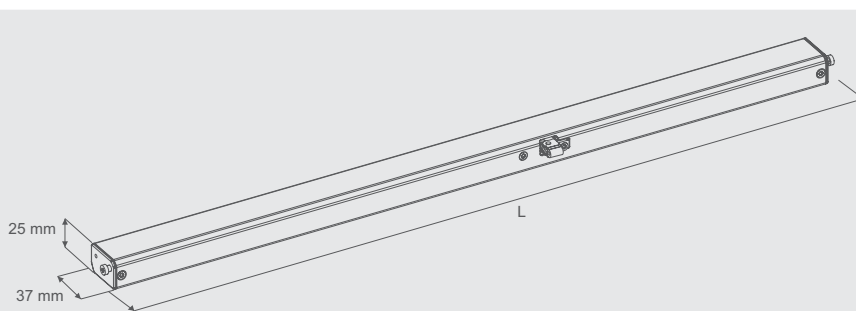

L = Length (incl. screws) - see table of items